

ÜrünFotoğraf

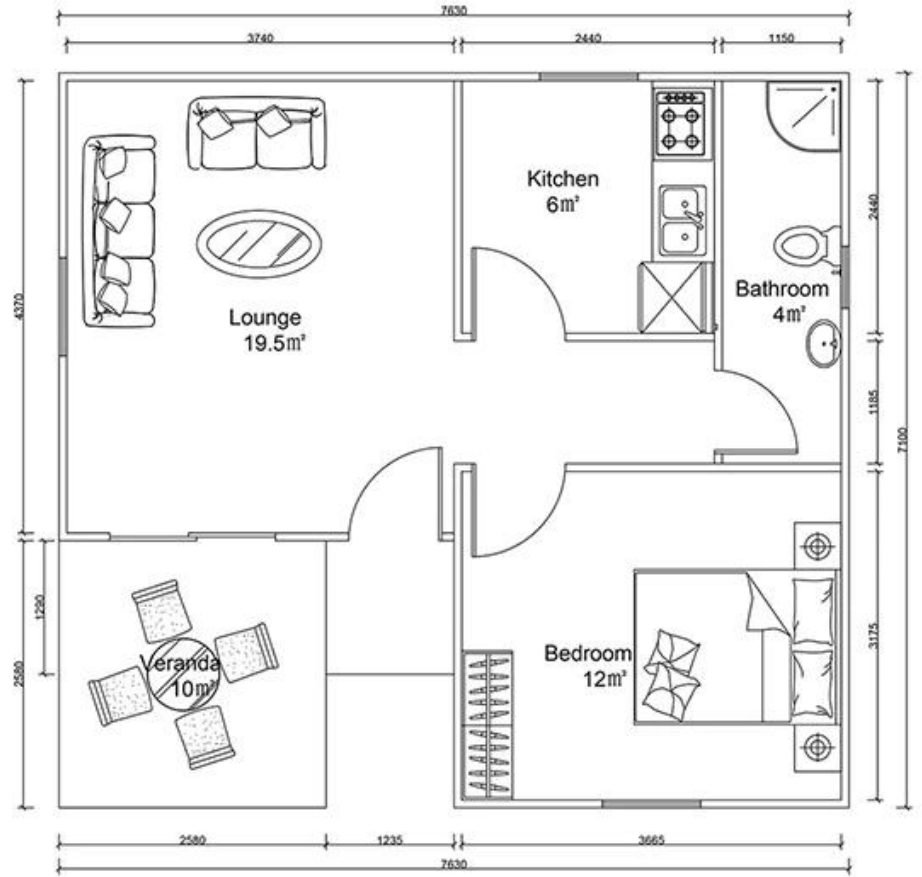



| NAME | DESCRIPTION | UNIT | THEORY QTY | LOSS RATE | UNIT | ACTUAL QTY |
|---|--|----------------|-------------|-----------|----------------|------------|
| LGS Structure | | | | | | |
| steel structure | | m ² | 54.5 | 1 | T | 1.80 |
| fittings | | set | 54.5 | 1 | m ² | 54.50 |
| Wall System | | | | | | |
| External wall OSB board | 1220*2440*9mm | m ² | 129 | 1.15 | pc | 51.51 |
| External wall unidirectional breath paper | | m ² | 132.42 | 1.2 | m ² | 158.90 |
| External wall metal carved board | 381*3800*16mm +381*4500*16mm | m ² | 129 | 1.15 | m ² | 148.35 |
| Internal wall OSB board | 1220*2440*9mm | m ² | 95.718 | 1.12 | pc | 37.22 |
| Internal wall gypsum board | 1200*2400*9mm | m ² | 95.718 | 1.12 | pc | 37.22 |
| Wet district fiber cement board | 1220*2440*10mm | m ² | 54.572 | 1.12 | pc | 21.22 |
| Insulation System | | | | | | |
| Glasswool Insulation | T75mm, 12 m ² /roll 16Kg/m3 | m ² | 139.645 | 1.1 | roll | 12.80 |
| Glasswool insulation(under roof) | T75mm, 12 m ² /roll 16Kg/m3 | m ² | 54.5 | 1.1 | roll | 5.00 |
| External wall XPS board | 1200*600*40mm | m ² | 129 | 1.05 | pc | 188.13 |
| Roof System | | | | | | |
| Roof OSB board/OSB | 1220*2440*12mm | m ² | 96 | 1.15 | pc | 38.33 |
| self-paste waterproof coil | T1.5mm, -15°C, 20 m ² /roll | m ² | 96 | 1.2 | roll | 5.76 |
| Roof tile | asphalt tile | m ² | 96 | 1.2 | pack | 41.14 |
| Roof ridge tile | asphalt tile | m | 29.1 | 1.1 | pack | 4.00 |
| Roof eaves pvc molding /PVC | 6m/pc | m | 54 | 1.1 | pc | 9.90 |
| PVC closing strip/PVC | 4m/pc | m | 54 | 1.1 | pc | 14.85 |
| Metal carved board under roof eaves | 381*3800*16mm | m ² | 32.4 | 1.2 | pc | 27.00 |
| Door & Window | | | | | | |
| PVC window | | m ² | 3.42 | 1 | m ² | 3.42 |
| PVC door | | m ² | 9.8 | 1 | m ² | 9.80 |
| Accessories for door sill/windowsill | 1220*2440*10mm | m | 40.9 | 1.1 | pc | 3.12 |
| Water&Electric System | | | | | | |
| Water Pipes | | m ² | 54.5 | 1 | m ² | 54.50 |
| Electric system | Include weak current,exclude socket/switch/light,etc | m ² | 54.5 | 1 | m ² | 54.50 |
| Decoration Accessories System | | m ² | 54.5 | 1 | m ² | 54.50 |
| Hardware Accessories System | | m ² | 54.5 | 1 | m ² | 54.50 |
| TOTAL EXW cost | | | \$11,876.44 | | | |
| TOTAL FOB Qingdao | | | \$12,776.44 | | | |
| TOTAL CIF XX | | | \$12,840.32 | | | |

