

□□□□□□□□□□□□□□

# Heya-2Q02

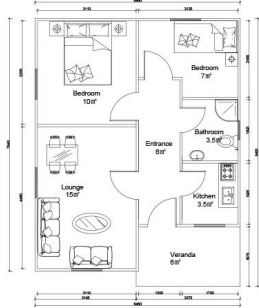

NAME	DESCRIPTION	UNIT	THEORY QTY	LOSS RATE	UNIT	ACTUAL QTY
<b>LGS Structure</b>						
steel structure		m <sup>2</sup>	53	1.00	T	1.75
fittings		set	53	1.00	m <sup>2</sup>	53.00
<b>Wall System</b>						
External wall OSB board	1220*2440*9mm	m <sup>2</sup>	118.3	1.15	pc	47
External wall unidirectional breath paper		m <sup>2</sup>	124	1.20	m <sup>2</sup>	149
External wall metal carved board	381*3800*16mm+381*4500*16mm	m <sup>2</sup>	118.3	1.15	m <sup>2</sup>	136
Internal wall OSB board	1220*2440*9mm	m <sup>2</sup>	127.5	1.12	pc	50
Internal wall gypsum board	1200*2400*9mm	m <sup>2</sup>	127.5	1.12	pc	50
Wet district fiber cement board	1220*2440*10mm	m <sup>2</sup>	48.5	1.12	pc	19
<b>Insulation System</b>						
Glasswool insulation	T75mm, 12 m <sup>2</sup> /roll 16Kg/m <sup>3</sup>	m <sup>2</sup>	147.15	1.10	roll	13
Glasswool insulation(under roof)	T75mm, 12 m <sup>2</sup> /roll 16Kg/m <sup>3</sup>	m <sup>2</sup>	53	1.10	roll	5
External wall XPS board	1200*600*40mm	m <sup>2</sup>	118.3	1.05	pc	173
<b>Roof System</b>						
Roof OSB board OSB	1220*2440*12mm	m <sup>2</sup>	92	1.15	pc	37
self-paste waterproof coil	T1.5mm, -15°C, 20 m <sup>2</sup> /roll	m <sup>2</sup>	92	1.20	roll	6
Roof tile	asphalt tile	m <sup>2</sup>	92	1.20	pack	39
Roof ridge tile	asphalt tile	m	10.467	1.10	pack	1
Roof eaves pvc molding PVC	6m/pc	m	42.584	1.10	pc	8
PVC closing strip PVC	4m/pc	m	42.584	1.10	pc	12
Metal carved board under roof eaves	381*3800*16mm	m <sup>2</sup>	25.55	1.20	pc	21
<b>Door &amp; Window</b>						
PVC window		m <sup>2</sup>	5.7	1.00	m <sup>2</sup>	5.70
PVC door		m <sup>2</sup>	10.8	1.00	m <sup>2</sup>	10.80
Accessories for door sill/window/sill	1220*2440*10mm	m	52.2	1.10	pc	4
<b>Water&amp;Electric System</b>						
Water Pipes		m <sup>2</sup>	53	1.00	m <sup>2</sup>	53.00
Electric system	Include weak current, exclude socket, switch, light, etc.	m <sup>2</sup>	53	1.00	m <sup>2</sup>	53.00
<b>Decoration Accessories System</b>						
		m <sup>2</sup>	53	1.00	m <sup>2</sup>	53.00
<b>Hardware Accessories System</b>						
		m <sup>2</sup>	53	1.00	m <sup>2</sup>	53.00
<b>TOTAL EXW cost</b>				\$11,582.60		
<b>TOTAL FOB Qingdao</b>				\$12,482.60		
<b>TOTAL CIF XX</b>				\$14,545.02		















