

Китайский крошечный сборный дом с 1 спальней

Описание продукта

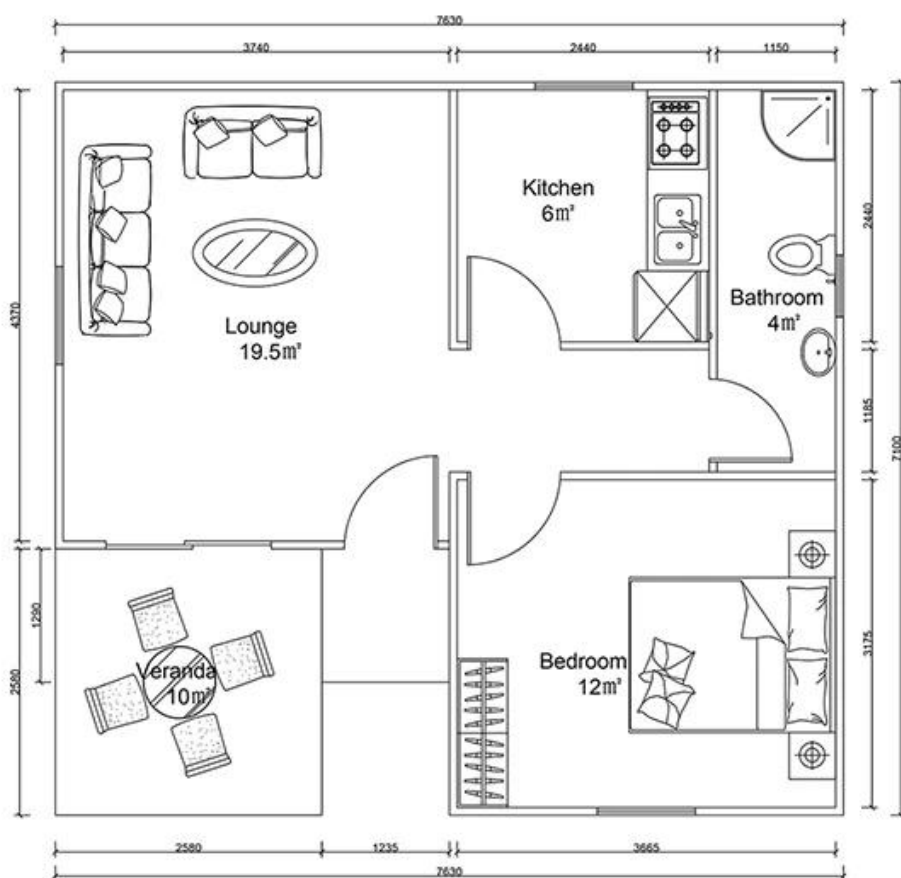

<o:p>

<o:p>



<o:p>

QUOTATION SHEET

NO.	HY-S01	DATE	
Item	Description	Qty	Unit
Steel frame	Beam HN200*100\HN250*125\square tube120x5mm	54.5	m2
Exterior Wall	90mm ASA Sandwich Panel/90mm ASA	129	m2
Interior Wall	90mm ASA Sandwich Panel/90mm ASA	36.75	m2
Roof	90mm ASA Sandwich Panel/90mm	96	m2
	asphalt shingles	96	m2
Door	Out door (Steel door)/900*2000mm	1	pcs
	Inside door(MDF door)/800*2000mm	2	pcs
	Aluminium-alloy glass door	3.2	m2
	bathroom door/PVC800mm x 2000mm(water proof)	1	pcs
Windows	PVC sliding window /PVC950(W)*1000mm(H)	3	pcs
	PVC sliding window /PVC950(W)*600mm(H)	1	pcs
Accessories	kinds of necessary screws\U type clipsealant\Special binder	54.5	m2
Ceiling	PVC strip ceiling/PVC	54.5	m2
Floor	ceramic tile/ 800x800mm	54.5	m2
Drain system	drain pipes \gutter	38	m
EXW COST		\$10,699.50	
Inland Cost	40HC container loading	1	pcs
	20GP container loading	0	pcs
Workers loading Cost	40ft/20ft container	1	pcs
Total Amount /(FOB Qingdao)		\$11,649.50	