

Descrição do Produto

Heya-2S02

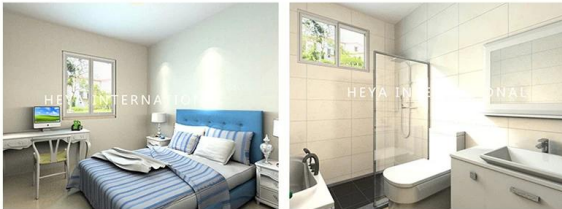
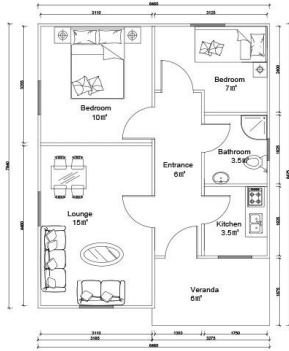

QUOTATION SHEET

NO.	HY-2S02	DATE	
Item	Description	Qty	Unit
Steel frame	Beam HN200*100\HN250*125\square tube120x5mm	53	m2
Exterior Wall	90mm ASA Sandwich Panel/90mm ASA	105	m2
Interior Wall	90mm ASA Sandwich Panel/90mm ASA	59.598	m2
Roof	90mm ASA Sandwich Panel/90mm	69.7	m2
	asphalt shingles	69.7	m2
Door	Out door (Steel door)/900*2000mm	1	pcs
	Inside door(MDF door)/800*2000mm	4	pcs
	bathroom door/PVC800mm x 2000mm(water proof)	1	pcs
Windows	PVC sliding window /PVC950(W)*1000mm(H)	5	pcs
	PVC sliding window /PVC950(W)*600mm(H)	1	pcs
Accessories	kinds of necessary screws/U type clips/ant\Special binder	53	m2
Ceiling	PVC strip ceiling/PVC	53	m2
Floor	ceramic tile/ 800x800mm	53	m2
Drain system	drain pipes \gutter	28.5	m
EXW COST		\$9,737.07	
Inland Cost	40HC container loading	1	pcs
	20GP container loading	0	pcs
Workers loading Cost	40ft/20ft container	1	pcs
Total Amount (FOB Qingdao)		\$10,687.07	

