

# Quickly Built prefabricated hospital

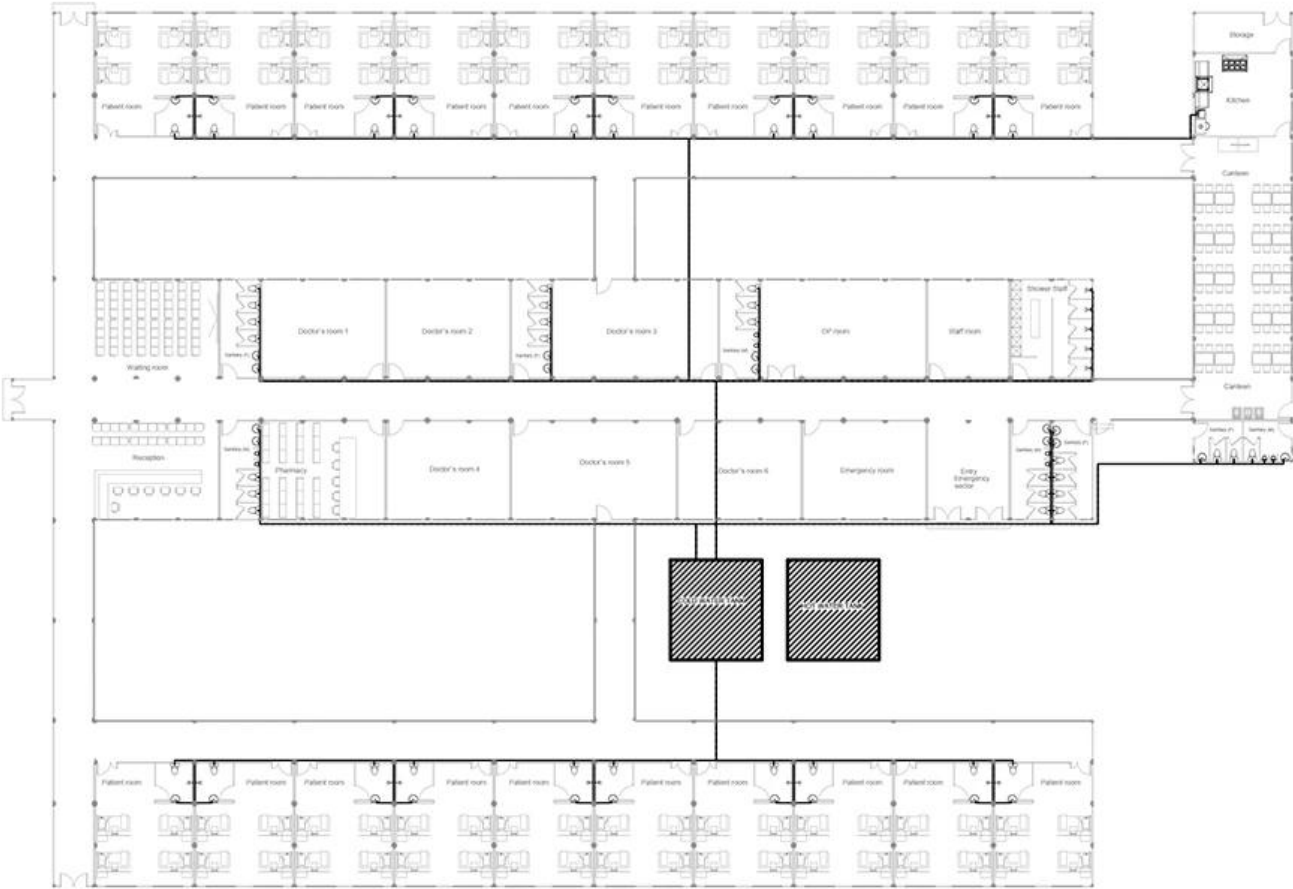

Inlet diagram (cold water)

Sort	Name	Specification
------	------	---------------

<b>Specification</b>	20'GP	Length:6055mm Width:2438m Height:2591mm Weight:2145KGS
	40'GP	Length:12192mm Width:2438mm Height:2591mm Weight:3650KGS
	40'HQ	Length:12192mm Width:2438mm Height:2896mm Weight:3800KGS
<b>Standard</b>	Wall	Material: steel
	Roof	Material: steel
	Door	Aluminium alloy, wood ,steel or customers' requirement
	Window	Aluminium alloy, wood or customers' requirement
	Decorative floor	PVC or laminated flooring in living area and aluminium panel in bathroom and kitchen or customers' requirement
	Water supply and Drainage system	Provided plan, design and construction or customers' requirement
	Electric system	Provided plan, design and construction or customers' requirement
	Resistant temperature	-50°C to 70°C
	Fire proof	B2 grade
	Earthquake resistance	8Grade
<b>Technical</b>	Wind resistant	120km/h