

[Prefab Steel Solution China](#) | Luxury Beautiful Steel Villas High Quality
Assembly Light Steel Frame Houses For Sale - Quality Integrated House

Product Photo





Ground floor

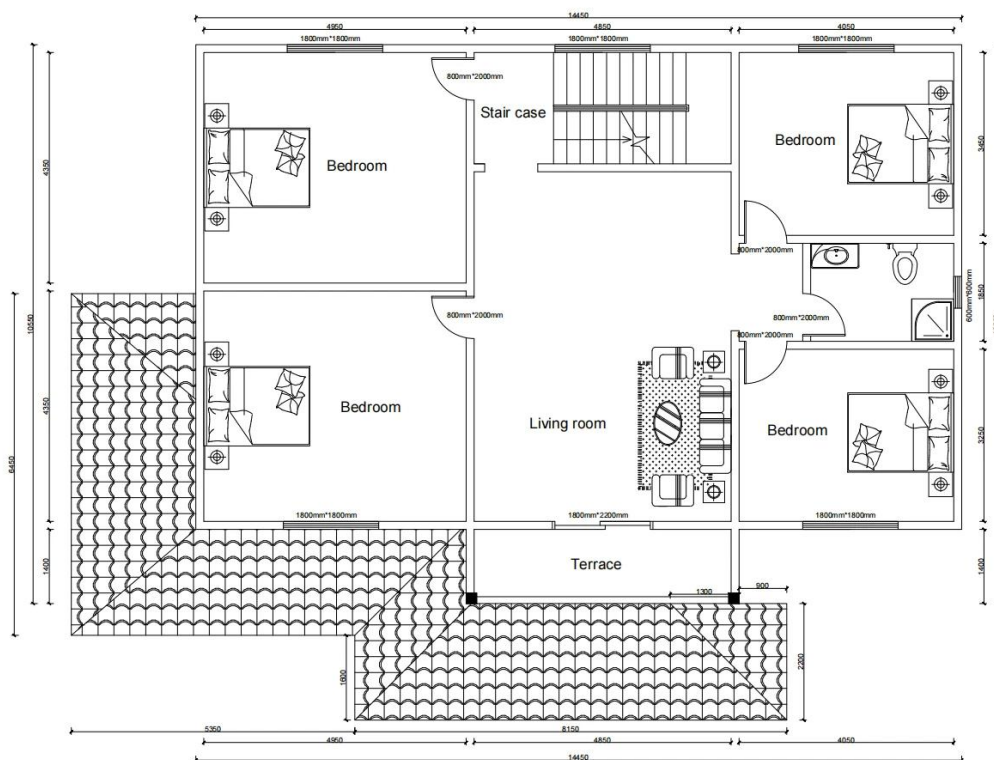

Second floor

No.	NAME	DESCRIPTION	UNIT	THEORY QTY	LOSS RATE	UNIT	ACTUAL QTY
□	LGS Structure/□□□□						
1	steel structure		□	280	1.00	T	11.20
2	fittings		set	280	1.00	□	280.00
□	Wall System/□□□□						
1	External wall OSB board/□□OSB□	1220*2440*9mm	□	333.5	1.30	pc	151
2	External wall unidirectional breath paper/□□□□□□□□ □		□	613.5	1.30	m2	798
3	External wall wooden support/□□□□	30*40*3000mm	m	1000.5	1.30	pc	434
4	External wall metal carved board/□□□□□□□□	381*3800*16mm +381*4500*16mm	□	333.5	1.30	□	434
5	Internal wall OSB board/□□OSB□	1220*2440*9mm	□	707.7	1.30	pc	319
6	Internal wall PVC board/□□□□□□	1200*2400*9mm	□	707.7	1.20	m2	849
7	Wet district fiber cement board/□□□□□□□□□□	1220*2440*10mm	□	122.53	1.30	pc	55
□	Insulation System/□□□□□□						
1	Glasswool Insulation /□□□□□□□□	T75mm□12□/roll 16Kg/m3	□	581.865	1.30	m2	756
2	Glasswool insulation(under roof)/□□□□□□(□□□□)	T75mm□12□/roll 16Kg/m3	□	260.1	1.30	m2	338
3	External wall XPS board/□□□□□□	1200*600*40mm	□	333.5	1.20	pc	556
□	Floor System/□□□□□□						
1	Floor surface OSB/□□OSB□	1220*2440*18mm	□	143.2	1.30	m2	186
2	Floor self-paste waterproof coil/□□□□□□□□□□	T1.5mm□-15℃□20□/roll	□	143.2	1.20	roll	9
3	Floor tile/□□□□	12mm	□	280	1.10	□	308
□	Roof System/□□□□□□						
1	Roof OSB board/OSB□	1220*2440*12mm	□	260.1	1.50	pc	135
2	self-paste waterproof coil/□□□□□□□□□□	T1.5mm□-15℃□20□/roll	□	260.1	1.40	roll	18
3	Roof tile/□□□	asphalt tile	□	260.1	1.50	pack	139
4	Roof ridge tile/□□□	asphalt tile	m	53.55	1.10	pack	7
5	Roof eaves pvc molding /PVC□□□	6m/pc	m	87.5	1.50	pc	22
6	PVC closing strip/PVC□□□	4m/pc	m	87.5	1.50	pc	33
7	Metal carved board under roof eaves/□□□□□□□□	381*3800*16mm	□	52.5	1.50	pc	55
□	Ceiling/□□□□						
1	pvc ceiling/pvc □□□	6000*200mm	□	280	1.20	□	280.00
2	pvc angle skirting/pvc□□		□	280	1.05	□	294.00
□	Door & Window/□□□□□□						
1	Alumunium double glaze window/□□□□		□	44.82	1.00	□	44.82
2	Steel and MDF door/□□□□□□□□□□		□	16	1.00	□	16.00
□	Water&Electric System/□□□□						
1	Water Pipes/□□□		□	280	1.00	□	280.00
2	Electric system/□□	Include weak current,exclude socket/switch/light,etc	□	280	1.00	□	280.00
□	Accessories System/□□		□	280	1.00	□	280.00
□	Loading /□□		□	280	1.00	□	280.00

Company Introduction

Shandong Quality is one of the best Chinese prefabricated housing solution supplier.

Our products include prefabricated house,container house, mobile homes, villas, light steel structure.

We have more 10 years experience in the industry, professional manufacture and procurement team, maintain long-term cooperative relationship with many well-known manufacturers.

Already finish Germany Refugee container house project,Zimbabwe Prefabricated Classroom Project, South Africa Prefab House,Uruguay Prefab Villages House project,and so on.

Our [China Prefab Homes Manufacturer](#) is committed to become your trusted partner, you focus on your area of expertise, let us help you deal with the temporary office and warehouse

of a comprehensive solution.



Our factory is located in the beautiful kite capital of Weifang, Shandong.

In recent years, the factory strength has been growing and developing,
and its production strength and quality services have won the praise of our clients from all
over the world.

We welcome every customer to visit the factory and inspect the quality of the [Prefabricated Steel Buildings Wholesales](#) product.