

Product Photo

Heya Group - Office Design

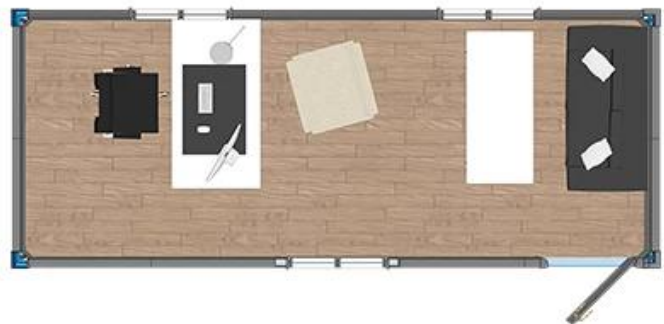
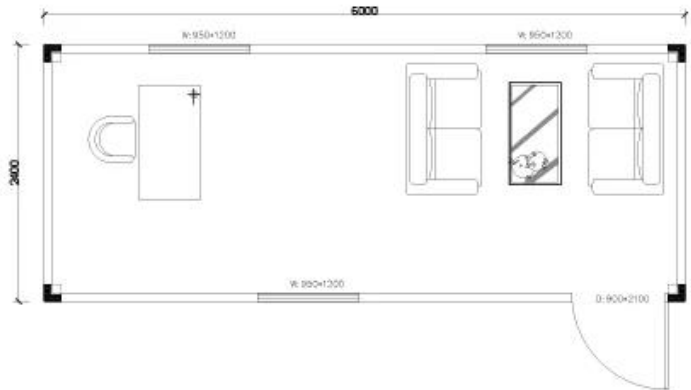

Flat Pack Container Solutions: Revolutionizing Modular Construction with Efficiency and Versatility

Flat pack containers represent the next evolution in modular design, offering unparalleled convenience, cost savings, and adaptability. These innovative structures are engineered to ship disassembled in compact, lightweight panels, enabling easy transportation and rapid on-site assembly. Ideal for remote locations, temporary projects, or scalable housing needs, flat pack containers redefine modern construction with their unique advantages:

1. Ultra-Efficient Transportation & Storage

Flat pack containers are designed to minimize shipping volume. Their collapsible panels and components reduce logistical costs by up to 60% compared to traditional pre-assembled units. This efficiency makes them ideal for hard-to-reach areas or projects with limited storage space.

2. Rapid On-Site Assembly

With intuitive interlocking systems and pre-drilled fittings, flat pack containers can be assembled in hours by a small team, eliminating the need for heavy machinery. This swift deployment is critical for emergency housing, disaster relief, or urgent infrastructure needs.

3. Cost-Effective Scalability

The flat pack model slashes expenses at every stage: lower shipping fees, reduced labor for assembly, and minimized material waste. Bulk purchasing of standardized kits further drives down costs, offering budget-friendly solutions for large-scale projects like worker camps or student housing.

4. [Prefab Offices Price In China](#) | Customizable Configurations

Flat pack systems allow endless flexibility. Panels can be combined to create single or multi-story units, open-plan spaces, or compartmentalized layouts. Optional add-ons—such as solar-ready roofs, insulation packages, or smart technology integration—tailor units to specific climates and functional needs.

5. Eco-Conscious Design

Constructed from lightweight yet durable materials (e.g., recycled steel, sustainable composites), flat pack containers prioritize sustainability. Their reusable, modular design supports circular economy principles, while energy-efficient features like thermal insulation and rainwater harvesting reduce long-term environmental impact.

6. Reusability & Portability

Unlike permanent structures, flat pack containers can be disassembled, relocated, or repurposed with ease. This adaptability ensures long-term value for industries like mining, tourism, or event management, where temporary or mobile facilities are essential.

Applications Across Industries

Emergency Response: Deploy instant shelters with essential utilities in crisis zones.

Remote Workforce Housing: Provide comfortable, quick-to-install accommodations for oil fields, construction sites, or renewable energy farms.

Urban Pop-Up Spaces: Create retail kiosks, clinics, or offices in crowded cities without lengthy permits or construction.

Eco-Tourism: Build low-impact lodges that blend into natural environments while minimizing disruption.

Flat pack containers merge cutting-edge engineering with practicality, offering a smarter, greener way to meet today's dynamic housing and infrastructure demands. By prioritizing efficiency, affordability, and sustainability, they empower businesses and communities to build faster, lighter, and with greater purpose.

Click Quality [Porta Cabin For Sale](#) for more products.





Certificate



Container Cabin For Sale | Focus on "Quality & Service", one stop service help you save cost, reduce your all worries, turn over perfect project.

A. Professional design and engineering team: Full solution for steel structure design B.

Procurement and Manufacture for all material for prefabricated building.

We have a professional procurement team to make sure all the materials are with good quality.

And our factory operation under ISO/CE/SGS standard, to make sure the fabrication works with high technology.

C. Site management & Installation supervision, We could send our engineers to help for the installation supervision,

you just need to prepare a team which know normal construction works will be O.K.