

Prefab Luxury Light Steel Structure Villa House

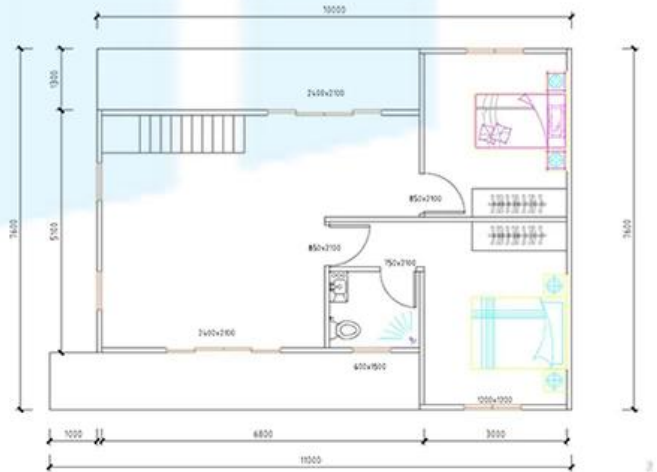

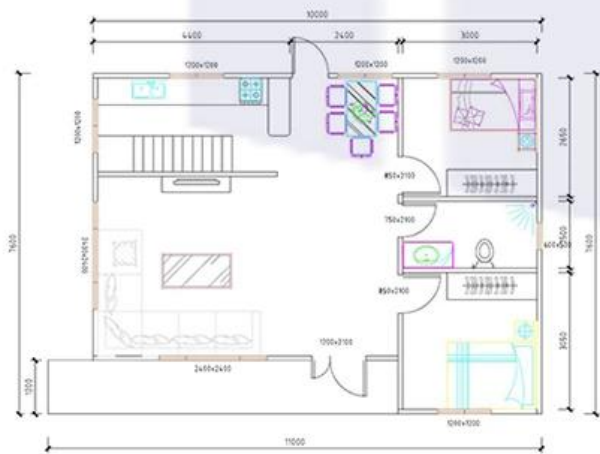

HEYA

PERFORMANCE COMPARISON BETWEEN WALL PANELS

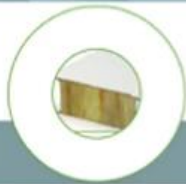
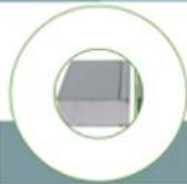

Item	EPS Sandwich Panel	PU Sandwich Panel	Rockwool Sandwich Panel	Glasswool Sandwich Panel	EPS Cement Sandwich Panel
Water Proof	★★★★★	★★★★★	★★★	★★★	★★★★★
Fire Proof	★★ <small>inflamming retarding</small>	★★★★★	★★★★★	★★★★★	★★★★★
Heat Insulation	★★★	★★★★★	★★★★★	★★★★★	★★★★★
Sound Insulation	★★★★★	★★★★★	★★★★★	★★★★★	★★★★★
Price Comparison	★★	★★★★★	★★★★★	★★★★★	★★★★★
Density Range	10-14kg/m3	35-40kg/m3	60-80kg/m3	30-50kg/m3	35-40kg/m3

Steel frame	C-type steel purlin and beam, square tube, steel channels, C100*50*20mm, galvanized
Exterior Wall	100 mm EPS Color Steel Sandwich Panel ,0.45mm steel sheet, 18kgs/m3, film protect
Interior Wall	75mm EPS Color Steel Sandwich Panel ,0.45mm steel sheet, 18kgs/m3, film protect
Roof	100 mm EPS Color Steel Sandwich Panel, 0.45mm, 18kgs/m3, cover asphalt shingles
Floor	PVC or laminated flooring in living area and aluminium panel in bathroom and kitchen or customers' requirement
Ceiling	PVC ceiling
Door	Out door (Steel Security exterior door)with lock 950*2000mm Inside door with lock 850*2000mm
Windows	PVC sliding window with fly screen, shutters, double glasses, 1900(W)*1900mm(H) for living house
	PVC sliding window with fly screen, double glasses, 1500(W)*1000mm(H) for living house, with shutter
	PVC sliding window with fly screen, double glasses 600(W)*600mm(H) , with shutter
Exterior wall decoration	PVC hang board
Out Drain systems (rain)	drain pipes , gutter
Accessories	kinds of necessary screws, sealant, ridge tile, packet eaves, color steel flash