

## **Product description**

## Heya-2B02-B

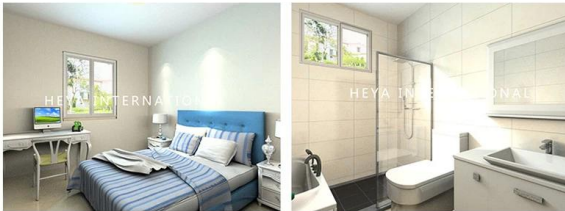
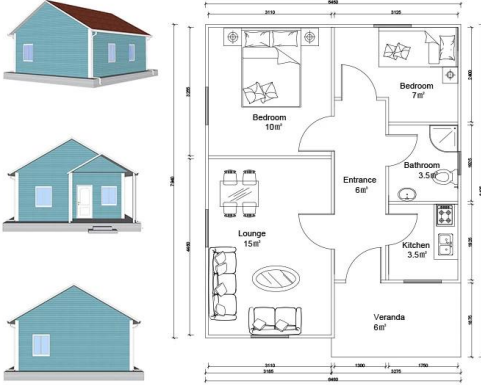

### BREAKDOWN QUOTATION SHEET

NO.	HY-2B02-B	DATE
Item	Description	Qty Unit
Steel frame	C-type steel purlin and beam, square tube, steel channels	53 m2
Exterior Wall	75mm EPS Color Steel Sandwich Panel, pre-cut, with film protection	105.2 m
Interior Wall	75mm EPS Color Steel Sandwich Panel, pre-cut, with film protection	58.8 m
Roof	75mm EPS Color Steel Sandwich Panel, pre-cut, with film protection	69.7 m
Ceiling	PVC ceiling	53 m2
Floor	Ceramic tile 800x800mm	53 m2
Roof decoration	Asphalt tile	70.2 m2
External Wall decoration	Metal carved plate	105 m2
Door	Out door (Steel door) 900*2000mm	1 pcs
	Bathroom door 800mm x 2000mm (water proof)	5 pcs
Windows	PVC sliding window 950(W)*1000mm(H)	5 pcs
	PVC sliding window 950(W)*600mm(H)	1 pcs
Drain system	Drain pipes ,gutter	28.5 m
Electric system		49 m2
Accessories	Kinds of necessary screws, sealant, ridge tile, packet eaves, flashing, channel iron	49 m2
Total Amount (Necessary Basic Fitting)		\$7,640.00
Inland Cost	40HC container loading	1 pcs
Workers loading Cost	40ft/20ft container	1 pcs
Total Amount		\$8,590.00

## Company Introduction

Shandong Heya Company is the best Chinese supplier of prefabricated house solutions.

Our products include prefabricated house, container house, mobile homes, villas, lightweight steel structure.

We have more than 10 years experience in the industry, professional manufacturing and procurement team,

maintain long-term cooperative relationship with many well-known manufacturers.

Germany Refugee Container House project, Zimbabwe Prefabricated Classroom Project, already completed

South Africa Prefab House, Uruguay Prefab Villages House project and so on.

Our company strives to become your trusted partner. You focus on your area of expertise.

Let us assist you in dealing with the temporary office and warehouse of a comprehensive solution.



Our factory is located in the beautiful dragon capital Weifang, Shandong.

In recent years, factory strength has grown and developed,

and its production strength and quality services have won the praise of our clients from all over the world.

We welcome every customer to visit the factory and to control the quality of the product.

## certificate



Focus on "quality and service". A single service helps you to save costs, alleviate all worries and implement the perfect project.

A. Professional design and engineering team: full solution for steel structure design B.

Procurement and production of all materials for prefabricated construction.

We have a professional procurement team to ensure that all materials are of good quality.

And our factory operates under ISO / CE / SGS standard to make sure the fabrication works with high-tech.

C. Site Management & Installation Supervision, We could send our engineers to help for the installation supervision,

All you have to do is prepare a team that knows that normal construction work is alright.

## **Packing & Shipping**

Packaging Details: 1, Delivery by 40'HQ shipping container. 2, 4 in 1 flat packaging

Delivery Details: 3-20 days after order



**our customers**





## FAQ

1, What's your payment term?

50% deposit by TT, 50% balance before loading container by TT; 100% LC at sight (total payment over \$ 100,000);

2, how about shipping?

We use 40HQ containers to ship the goods; Normally 40HQ container can load about 160-180 square meters house.

3, delivery time?

Depending on MOQ, normally we can ship by 10 days after deposit received.

4, how to install?

As a rule, we provide you with an installation drawing and, if required, also an installation video.

5, can you send workers to help me build house?

Considering labor costs, security and visa issues, we recommend that you send one or two engineers to lead and train your staff.

You must provide plane tickets, hotel and meal and \$ 100 per day for the engineering salary.