

# Produkto Larawan

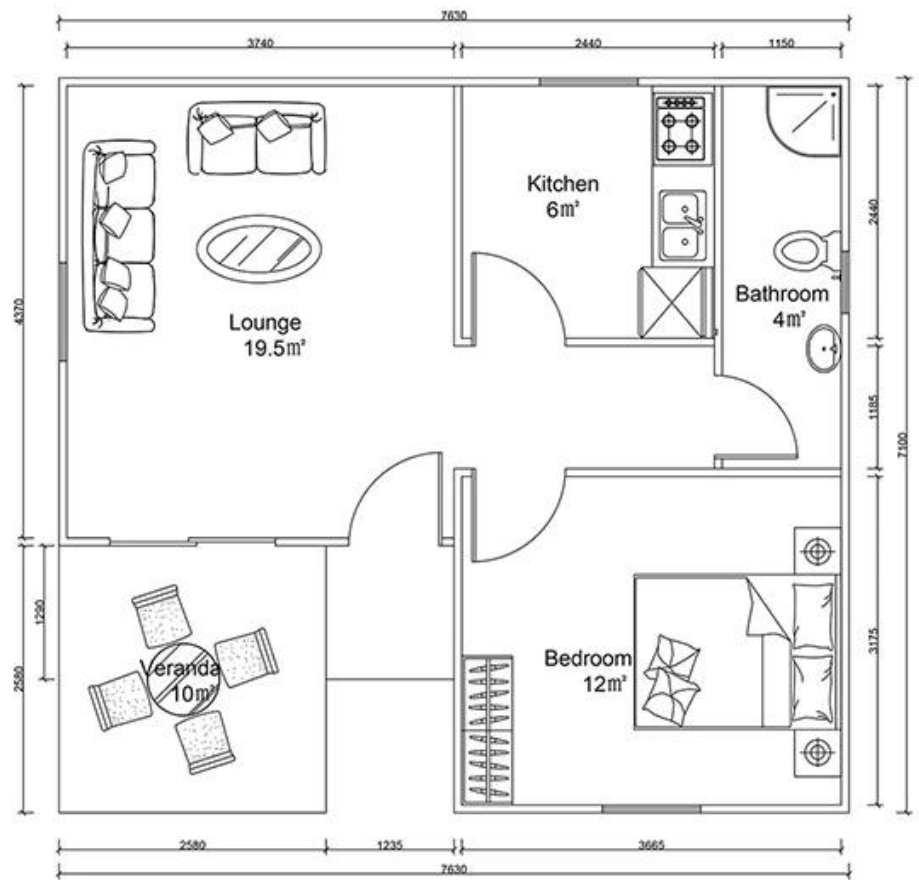



NAME	DESCRIPTION	UNIT	THEORY QTY	LOSS RATE	UNIT	ACTUAL QTY
<b>LGS Structure</b>						
steel structure		m <sup>2</sup>	54.5	1	T	1.80
fittings		set	54.5	1	m <sup>2</sup>	54.50
<b>Wall System</b>						
External wall OSB board	1220*2440*9mm	m <sup>2</sup>	129	1.15	pc	51.51
External wall unidirectional breath paper		m <sup>2</sup>	132.42	1.2	m <sup>2</sup>	158.90
External wall metal carved board	381*3800*16mm +381*4500*16mm	m <sup>2</sup>	129	1.15	m <sup>2</sup>	148.35
Internal wall OSB board	1220*2440*9mm	m <sup>2</sup>	95.718	1.12	pc	37.22
Internal wall gypsum board	1200*2400*9mm	m <sup>2</sup>	95.718	1.12	pc	37.22
Wet district fiber cement board	1220*2440*10mm	m <sup>2</sup>	54.572	1.12	pc	21.22
<b>Insulation System</b>						
Glasswool Insulation	T75mm, 12 m <sup>2</sup> /roll 16Kg/m3	m <sup>2</sup>	139.645	1.1	roll	12.80
Glasswool insulation(under roof)	T75mm, 12 m <sup>2</sup> /roll 16Kg/m3	m <sup>2</sup>	54.5	1.1	roll	5.00
External wall XPS board	1200*600*40mm	m <sup>2</sup>	129	1.05	pc	188.13
<b>Roof System</b>						
Roof OSB board/OSB	1220*2440*12mm	m <sup>2</sup>	96	1.15	pc	38.33
self-paste waterproof coil	T1.5mm, -15°C, 20 m <sup>2</sup> /roll	m <sup>2</sup>	96	1.2	roll	5.76
Roof tile	asphalt tile	m <sup>2</sup>	96	1.2	pack	41.14
Roof ridge tile	asphalt tile	m	29.1	1.1	pack	4.00
Roof eaves pvc molding /PVC	6m/pc	m	54	1.1	pc	9.90
PVC closing strip/PVC	4m/pc	m	54	1.1	pc	14.85
Metal carved board under roof eaves	381*3800*16mm	m <sup>2</sup>	32.4	1.2	pc	27.00
<b>Door &amp; Window</b>						
PVC window		m <sup>2</sup>	3.42	1	m <sup>2</sup>	3.42
PVC door		m <sup>2</sup>	9.8	1	m <sup>2</sup>	9.80
Accessories for door sill/windowsill	1220*2440*10mm	m	40.9	1.1	pc	3.12
<b>Water&amp;Electric System</b>						
Water Pipes		m <sup>2</sup>	54.5	1	m <sup>2</sup>	54.50
Electric system	Include weak current,exclude socket/switch/light,etc	m <sup>2</sup>	54.5	1	m <sup>2</sup>	54.50
<b>Decoration Accessories System</b>		m <sup>2</sup>	54.5	1	m <sup>2</sup>	54.50
<b>Hardware Accessories System</b>		m <sup>2</sup>	54.5	1	m <sup>2</sup>	54.50
<b>TOTAL EXW cost</b>			\$11,876.44			
<b>TOTAL FOB Qingdao</b>			\$12,776.44			
<b>TOTAL CIF XX</b>			\$12,840.32			

