

Quickly Built prefabricated hospital construction

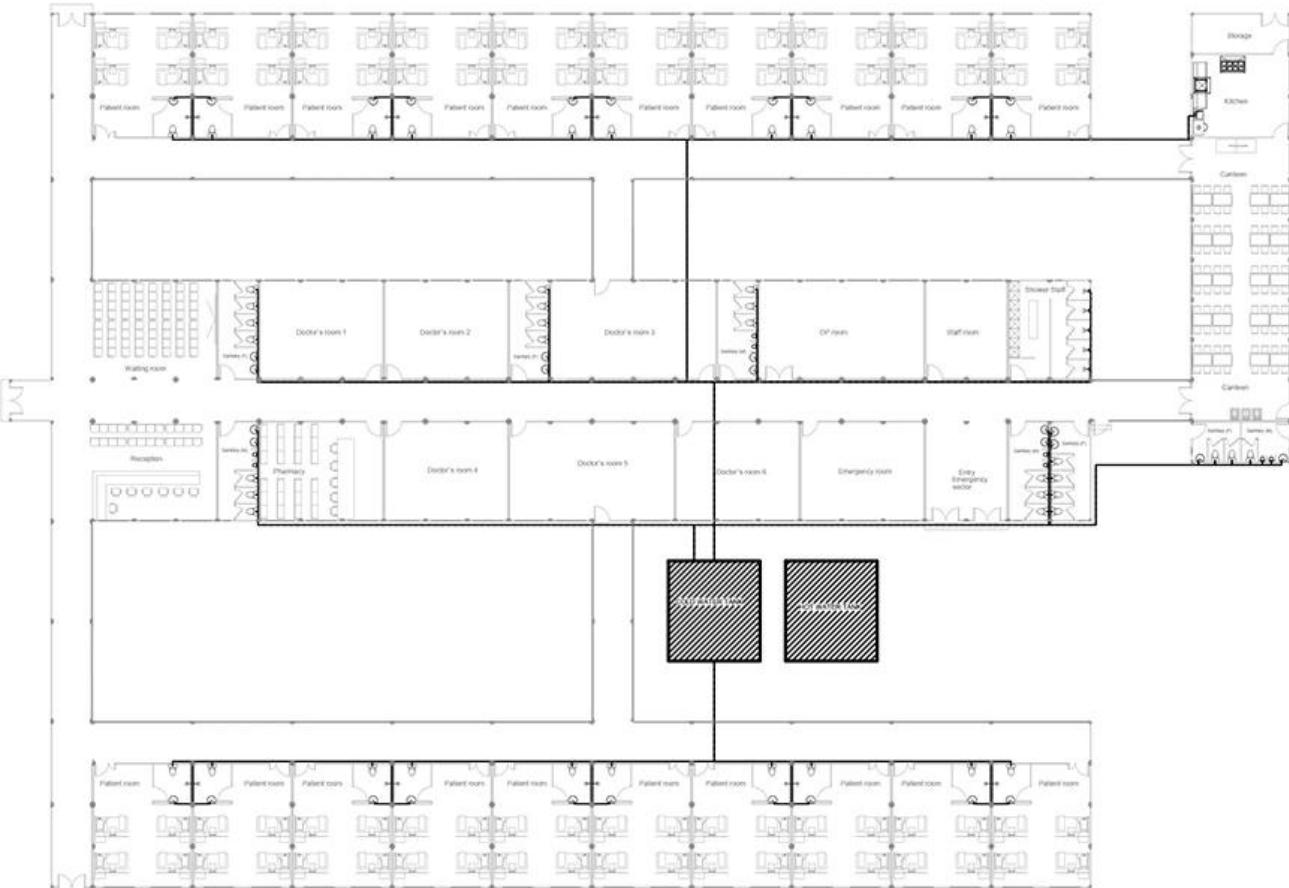

Inlet diagram (cold water)



| Sort | Name | Specification |
|---------------|-------|--|
| | 20'GP | Length:6055mm Width:2438m Height:2591mm Weight:2145KGS |
| Specification | 40'GP | Length:12192mm Width:2438mm Height:2591mm Weight:3650KGS |
| | 40'HQ | Length:12192mm Width:2438mm Height:2896mm Weight:3800KGS |

| | | |
|------------------|----------------------------------|--|
| Standard | Wall | Material: steel |
| | Roof | Material: steel |
| | Door | Aluminium alloy, wood ,steel or customers' requirement |
| | Window | Aluminium alloy, wood or customers' requirement |
| | Decorative floor | PVC or laminated flooring in living area and aluminium panel in bathroom and kitchen or customers' requirement |
| | Water supply and Drainage system | Provided plan, design and construction or customers' requirement |
| Technical | Electric system | Provided plan, design and construction or customers' requirement |
| | Resistant temperature | -50°C to 70°C |
| | Fire proof | B2 grade |
| | Earthquake resistance | 8Grade |
| | Wind resistant | 120km/h |