

HY-P07

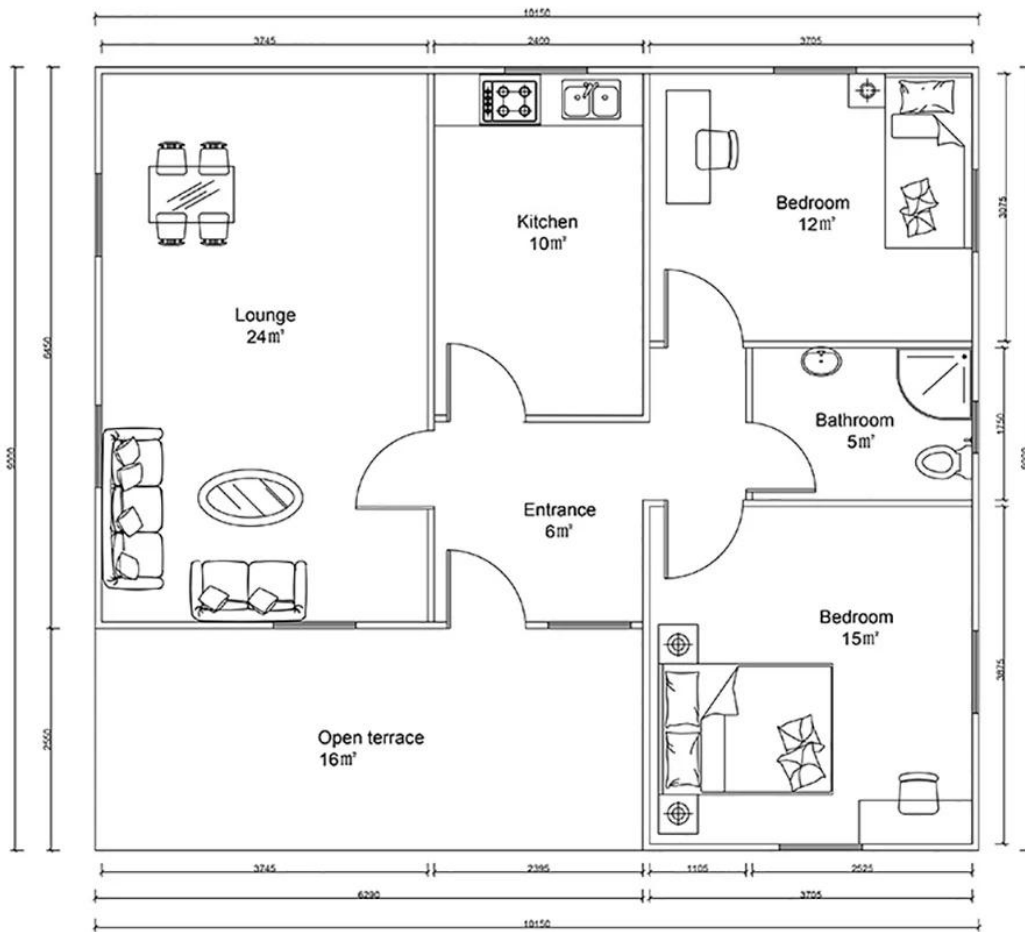

BREAKDOWN QUOTATION SHEET

| Item | Description | Qty | Unit |
|---------------------------------|--|------|------|
| Steel frame | C-type steel purlin and beam, square tube, steel channels | 75 | □ |
| Exterior Wall | 75mm EPS Color Steel Sandwich Panel, pre-cut, with film protection | 123 | m |
| Interior Wall | 75mm EPS Color Steel Sandwich Panel, pre-cut, with film protection | 70 | m |
| Roof | 75mm EPS Color Steel Sandwich Panel, pre-cut, with film protection | 87.6 | m |
| Ceiling | PVC ceiling/pvc | 75 | □ |
| | Gypsum board 600*600mm | | □ |
| | Fiber cement board | | □ |
| Base/Foundation | Plywood board | | □ |
| | PVC leather floor | | □ |
| Floor | Ceramic tile 800x800mm | 75 | □ |
| Roof decoration | Asphalt tile | 91.6 | □ |
| External Wall decoration | Metal carved plate | | □ |
| | PVC hanging board/PVC | | □ |
| Door | Out door (Steel door) 900*2000mm | 1 | pcs |
| | Inside door MDF 800*2000mm/MDF | | pcs |
| | Aluminium-alloy glass door | | □ |
| | PVC glass door | | □ |
| | Bathroom door 800mm x 2000mm (water proof) /PVC | 5 | pcs |
| Windows | PVC sliding window 950(W)*1000mm(H) | 9 | pcs |
| | PVC sliding window 950(W)*600mm(H) | 1 | pcs |
| | Aluminium-alloy window | | pcs |
| Drain system | Drain pipes ,gutter | 38 | m |
| Electric system | | 75 | □ |
| Accessories | Kinds of necessary screws, sealant, ridge tile, packet eaves, flashing, channel iron | 75 | □ |