

Heya Group - Worker Dormitory

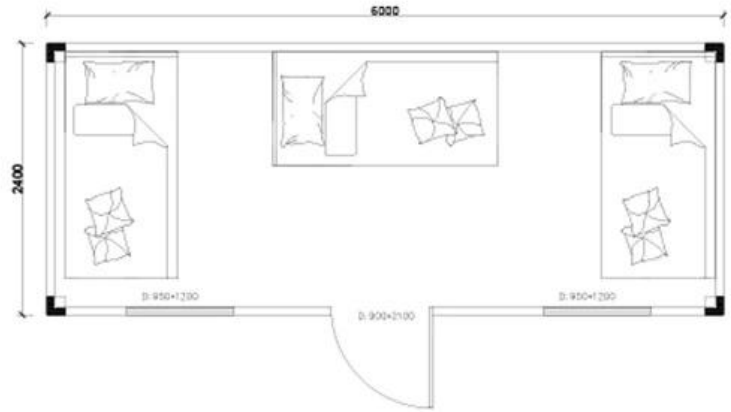





this product in youtube: [click the photo](#)



Product Detail

NORMAL QUALITY

NO	ITEM	DESCRIPTION
1	bottom frame	beamthickness 2.5mm secondary purlin C120*60*1.7mm 50mm glasswool insulation 0.23mmcovering tile beamthickness 2.5mm Z molding part
2	top frame	secondary purlin 80*40*1.3mm 50mm glasswool insulation+PE film 0.5mm steel sheet
3	column	2526*210*150*2.5mm
4	floor board	18mm fiber cement board
5	floor covering	1.6mm PVC vinyle flooring
6	steel door	T75 0.6mm,size 845*2035
7	PVC window	pvc sliding window 1130*1100 double glasses,flying screen

8	wall panel	V1150,75mm glasswool sandwich panel0.4/0.450KG/m ³ φ50mmPVC pipes 831*0.4mm ceiling
9	Accessories	75 channel PVC skirting 0.4mmcolumn cladding rivet,screw,glue,etc.
10	Electric	Industry plug,distribution box,4 socket,1switch,2 light
11	Lifetime	10 years

Technical Parameters

Technical Parameters

Overall weight	50~60kg/sqm
Seismic fortification intensity	8 grade
Wind-proof capacity	wind speed 20m/s, resist 8 grade wind
Floor loading capacity	150kg/sqm
Roof loading capacity	60kg/sqm
External wall bearing capacity	50kg/sqm