

## **Produktbeschreibung**

## Heya-2S02

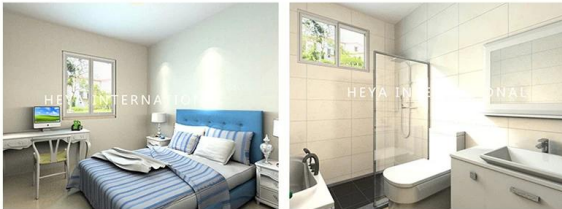
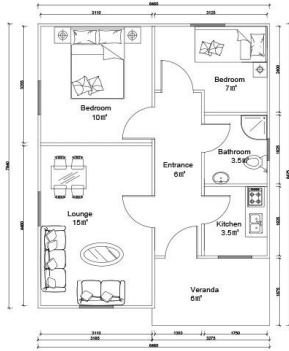

### QUOTATION SHEET

NO.	HY-2S02	DATE	
Item	Description	Qty	Unit
Steel frame	Beam HN200*100\HN250*125\square tube120x5mm	53	m2
Exterior Wall	90mm ASA Sandwich Panel\90mm ASA	105	m2
Interior Wall	90mm ASA Sandwich Panel\90mm ASA	59.598	m2
Roof	90mm ASA Sandwich Panel\90mm	69.7	m2
	asphalt shingles	69.7	m2
Door	Out door (Steel door)\900*2000mm	1	pcs
	Inside door(MDF door)\800*2000mm	4	pcs
	bathroom door/PVC800mm x 2000mm(water proof)	1	pcs
Windows	PVC sliding window /PVC950(W)*1000mm(H)	5	pcs
	PVC sliding window /PVC950(W)*600mm(H)	1	pcs
Accessories	kinds of necessary screws\U type clips\ant\Special binder	53	m2
Ceiling	PVC strip ceiling/PVC	53	m2
Floor	ceramic tile/ 800x800mm	53	m2
Drain system	drain pipes \gutter	28.5	m
<b>EXW COST</b>		<b>\$9,737.07</b>	
Inland Cost	40HC container loading	1	pcs
	20GP container loading	0	pcs
Workers loading Cost	40ft/20ft container	1	pcs
<b>Total Amount (FOB Qingdao)</b>		<b>\$10,687.07</b>	

