

□□□□□ □□□

# Heya-2Q05

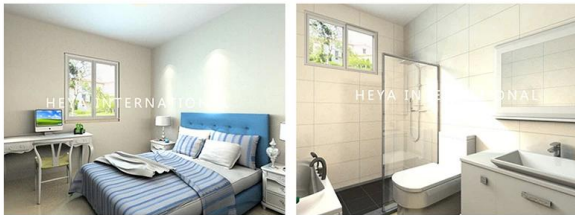
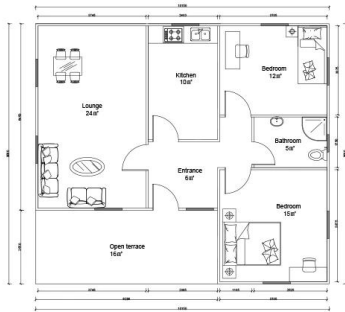

NAME	DESCRIPTION	UNIT	THEORY QTY	LOSS RATE	UNIT	ACTUAL QTY
<b>LGS Structure</b>						
steel structure		m²	75.00	1.00	T	2.48
fitings		set	75.00	1.00	m²	75.00
<b>Wall System</b>						
External wall OSB board	1220*2440*9mm	m²	156.76	1.15	pc	62.60
External wall unidirectional breath paper		m²	168.16	1.20	m²	201.79
External wall metal carved board	381*3800*16mm → 381*4500*16mm	m²	156.76	1.15	m²	180.27
Internal wall OSB board	1220*2440*9mm	m²	206.00	1.12	pc	80.11
Internal wall gypsum board	1200*2400*9mm	m²	206.00	1.12	pc	80.11
Wet district fiber cement board	1220*2440*10mm	m²	71.50	1.12	pc	27.81
<b>Insulation System</b>						
Glasswool Insulation	T75mm, 12 m²/roll 16Kg/m³	m²	217.13	1.10	roll	19.90
Glasswool insulation(under roof)	T75mm, 12 m²/roll 16Kg/m³	m²	96.10	1.10	roll	8.81
External wall XPS board	1200*600*40mm	m²	156.76	1.05	pc	228.61
<b>Roof System</b>						
Roof OSB board/OSB	1220*2440*12mm	m²	70.83	1.15	pc	28.28
self-paste waterproof coil	T1.5mm, -15°C, 20 m²/roll	m²	70.83	1.20	roll	4.25
Roof tile	asphalt tile	m²	70.83	1.20	pack	30.36
Roof ridge tile	asphalt tile	m	15.60	1.10	pack	2.15
Roof eaves pvc molding PVC	6m/pc	m	48.20	1.10	pc	8.84
PVC closing strip PVC	4m/pc	m	48.20	1.10	pc	13.26
Metal carved board under roof eaves	381*3800*16mm	m²	28.92	1.20	pc	24.10
<b>Door &amp; Window</b>						
PVC window		m²	11.40	1.00	m²	11.40
PVC door		m²	10.80	1.00	m²	10.80
Accessories for door sill/window sill	1220*2440*10mm	m	72.40	1.10	pc	5.53
<b>Water&amp;Electric System</b>						
Water Pipes		m²	75.00	1.00	m²	75.00
Electric system	include weak current,excluide socket,switch,light,etc	m²	75.00	1.00	m²	75.00
Decoration Accessories System		m²	75.00	1.00	m²	75.00
Hardware Accessories System		m²	75.00	1.00	m²	75.00
<b>TOTAL EXW cost</b>				\$14,817.67		
<b>TOTAL FOB Qingdao</b>				\$15,717.67		
<b>TOTAL CIF XX</b>				\$17,796.25		

Shandong Heya .

Shandong Heya .

Shandong Heya .

Shandong Heya .

Shandong Heya .

Shandong Heya .

Shandong Heya .

Shandong Heya .

Shandong Heya .



Shandong Heya .

Shandong Heya .

Shandong Heya .

□□□□□ □□□□ □□□□ □□□□□ □□□□□ □□□□ □□□□ □□□□.

□□□□□



□□ □□□□□ □□□□□□ □□□□□ □□□ □□ □□□□□ □□□□□ □□□□□ □□□□ □□□□ □□□□□.

□□□□□ □□□□□ □□□□□ □□□□□ □□□□ □□□□□ □□□□□ □□□□□ □□□□ □□□□.

□□□□□□ □□□□□□ □□□□□□ □□□□□ □□□□ □□□□□□ □□□□□□□□.

□□□□ □□□□□ □□ □□□□□ □□□□ □□ □□ □□□□□ □□□□□□ □□□□ □□□□□.

□□□ □□□□□ □□□□□□ □□□□□□□□ □□ □□□□ □□ □□□□□ □ □□□□□□□□ □□□□□□□.

□□□ □□□□□□□ □□ □□□□□□□ □□□□□□ □□ □□□□□ □ □□□□□□ □□□□□ □□□□□ □□□□□.

□□□□□" □□□□□ □□□□□□□ □□□□□ □□□□□ □□ □□□□ □□□□□ □□□ □□□□□□□□.

□□□□□ □□□□□□□ □□□□□□□

40 □□□□□ □□□□□ □□□□□□ □□□□□ □ 1 :□□□□□□□ □□□□□□'hq. 2 □ 4 □□□□□□□ □□□□□□□ 1 □□

□□□□□□ □□□ □□□□ 20-3 :□□□□□□□ □□□□□□□



□□□□□□□





□□□□□□□□

1 □ □□□□□ □□□□ □□ □□

50□ □□□□□ □□□□□ tt □ 50□ □□□□□ □□□□□□□ □□□□ □□ □□□□□□ tt. 100 □ LC □□□□□) □□□□□ □□ □ (□□□□□ 100□000 □□ □□□□ □□□□□□□□)

2 □ □□□□□ □□ □□□□

40 □□□□□ □□□□□□hq 40 □□□□□ □□□□□ .□□□□□□□ □□□□□HQ □□□□ □□□ 180-160 □□□□□ □□□□□ □□□□□ □□□□□□.

