

□□□□□□ □□□

Heya-2Q02

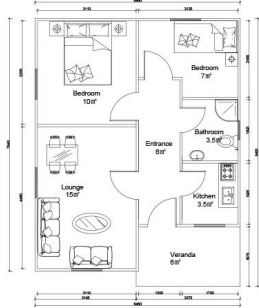

NAME	DESCRIPTION	UNIT	THEORY QTY	LOSS RATE	UNIT	ACTUAL QTY
LGS Structure						
steel structure		m ²	53	1.00	T	1.75
fittings		set	53	1.00	m ²	53.00
Wall System						
External wall OSB board	1220*2440*9mm	m ²	118.3	1.15	pc	47
External wall unidirectional breath paper		m ²	124	1.20	m ²	149
External wall metal carved board	381*3800*16mm+381*4500*16mm	m ²	118.3	1.15	m ²	136
Internal wall OSB board	1220*2440*9mm	m ²	127.5	1.12	pc	50
Internal wall gypsum board	1200*2400*9mm	m ²	127.5	1.12	pc	50
Wet district fiber cement board	1220*2440*10mm	m ²	48.5	1.12	pc	19
Insulation System						
Glasswool insulation	T75mm, 12 m ² /roll 16Kg/m ³	m ²	147.15	1.10	roll	13
Glasswool insulation(under roof)	T75mm, 12 m ² /roll 16Kg/m ³	m ²	53	1.10	roll	5
External wall XPS board	1200*600*40mm	m ²	118.3	1.05	pc	173
Roof System						
Roof OSB board OSB	1220*2440*12mm	m ²	92	1.15	pc	37
self-paste waterproof coil	T1.5mm, -15°C, 20 m ² /roll	m ²	92	1.20	roll	6
Roof tile	asphalt tile	m ²	92	1.20	pack	39
Roof ridge tile	asphalt tile	m	10.467	1.10	pack	1
Roof eaves pvc molding PVC	6m/pc	m	42.584	1.10	pc	8
PVC closing strip PVC	4m/pc	m	42.584	1.10	pc	12
Metal carved board under roof eaves	381*3800*16mm	m ²	25.55	1.20	pc	21
Door & Window						
PVC window		m ²	5.7	1.00	m ²	5.70
PVC door		m ²	10.8	1.00	m ²	10.80
Accessories for door sill/window/sill	1220*2440*10mm	m	52.2	1.10	pc	4
Water&Electric System						
Water Pipes		m ²	53	1.00	m ²	53.00
Electric system	Include weak current, exclude socket, switch, light, etc.	m ²	53	1.00	m ²	53.00
Decoration Accessories System						
		m ²	53	1.00	m ²	53.00
Hardware Accessories System						
		m ²	53	1.00	m ²	53.00
TOTAL EXW cost				\$11,582.60		
TOTAL FOB Qingdao				\$12,482.60		
TOTAL CIF XX				\$14,545.02		

Shandong Heya

Shandong Heya .

Shandong Heya .

Shandong Heya .

Shandong Heya .

Shandong Heya .

Shandong Heya .

Shandong Heya .

Shandong Heya .



Shandong Heya .

Shandong Heya .

Shandong Heya .

□□□□□□ □□□□□□

40 □□□□□ □□□□□ □□□□□□ □□□□□ □ 1 :□□□□□□□ □□□□□□'hq. 2 □ 4 □□□□□ □□□□□ 1 □□

□□□□□□ □□□ □□□□□ 20-3 :□□□□□□□ □□□□□□□



□□□□□□





□□□□□□□□

1 □ □□□□□ □□□□ □□ □□

□□□ □□ □□□□□□ □□□□ □□□ □ 50 □□□□□ □ □□□□□□ □□□□□□ □□ □ 50 □□□□□ TT 100 □ □ LC □ (□□□□□ 100□000 □□ □□□□□□□□ □□□□□) □□□□□ □□

2 □ □□□□□□ □□ □□□□

40 □□□□□ □□□□□ □□□□□ HQ 40 □□□□□□ □□□□ □ □□□□ .□□□□□□ □□□□□ HQ 180 □□□ 160 □□□□□ □□□□□ □□□□□ □□ □□□□ □□□.

