



PREFABRICATED TEMPORARY SPACE SOLUTION

Flexible | Energy saving | Environmental friendly | Cost effective

PRODUCT INTRODUCTION

Container module consists of top structure, base structure, corner post and interchangeable wallboard, and uses modular design and production technology to make the container into standardized components and assemble those components on site. This product takes the container as a basic unit, the structure uses special cold rolled galvanized steel, wall materials are all non-combustible materials, plumbing & electrical and decoration & functional facilities are all prefabricated in the factory completely, no further construction, ready to be used after assembly and lifting on-site. The container can be used independently or combined into spacious room and multi-story building through different combining in horizontal and vertical direction.

The structure of container module is simple, safe and lower requirements for foundation, with the characteristics of quick assembling, less transportation cost, long service life, etc. No loss for disassembly and assembly, no construction waste, and can be used as an office, dormitory, dining hall, bathroom, entertainment and a combination of large space, to meet all kinds of commercial housing requirements, such as the construction sites, municipal temporary housing, field operation barracks, emergency resettlement housing, schools, hospitals, tourism Inn, etc.

It's featured by prefabricated, flexible, energy saving and environmental friendly and so on. Thus, it is called "Green building"

PRODUCT STRUCTURE

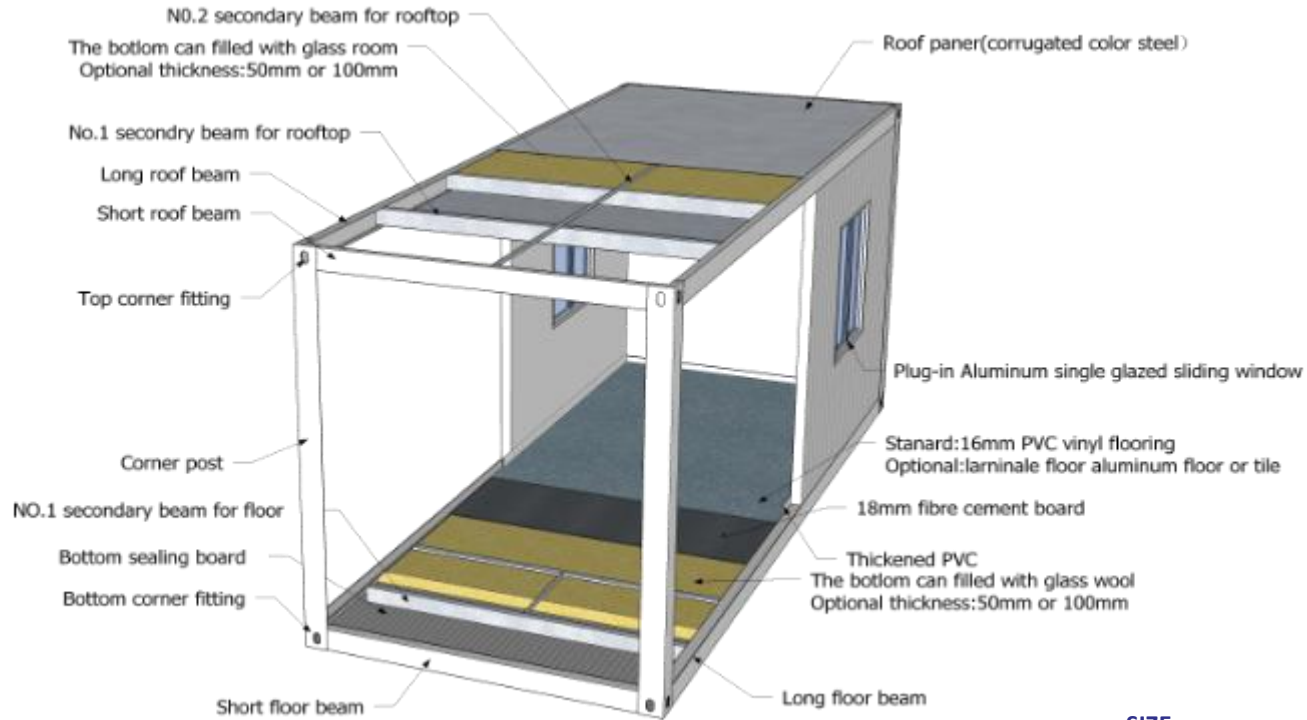

SIZE:

6055*3000*2896mm

6055*2435*2896mm

PRODUCT STRUCTURE

Weather Load	Seismic	Floor Live Load	Roof Live Load	Heat Transmission Coefficient	Wall Load
0.6 kn/m ²	Grade 8	2.0 kn/m ²	1.0 kn/m ²	0.35 kcal/m ² he	0.6kn/m ²

ADVANTAGE

Simple structure	Assembling/Disassemble conveniently	Lower requirements for foundation	Long service life	Less transportation cost
------------------	-------------------------------------	-----------------------------------	-------------------	--------------------------

FRAME COLOR

MORE FRAME COLOR CAN BE CUSTOMIZED THROUGH RAL COLOR CHART DEPEND ON ORDER QUANTITY



Yellow



Blue



Gray



Red

We are showing some standard configurations below. However, You can change the design of the containers, windows and door places. The furniture places are also just for your information and you can also change them too.

All units are made up with standard 20 and 40 ft containers. So it is easy to transport, and assemble. If you want, you can add extra containers for bigger places or you can ask for smaller containers for places. You can change your camp place easily with these units.

We are sending these units(containers) all over the world,such as Europe, Middleeast, Africa and Americas..

CONFIGURATIONS

Juniors Module (3-6 sleepers)

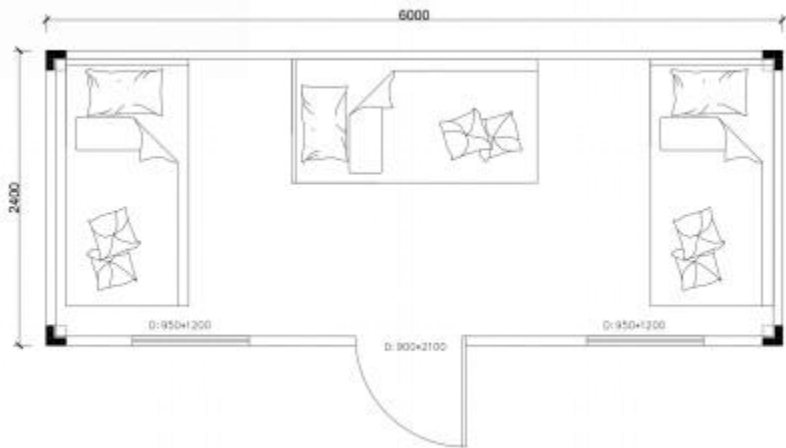

CONFIGURATIONS

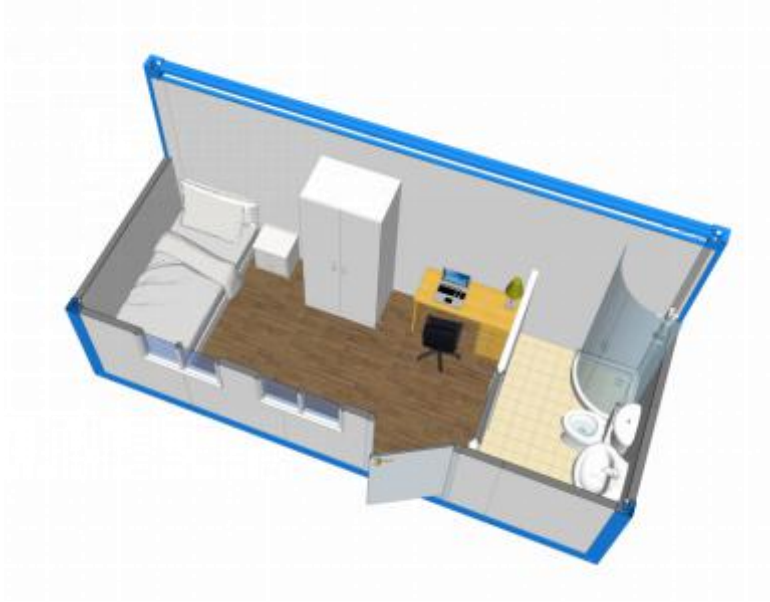

VIP Accommodation Module

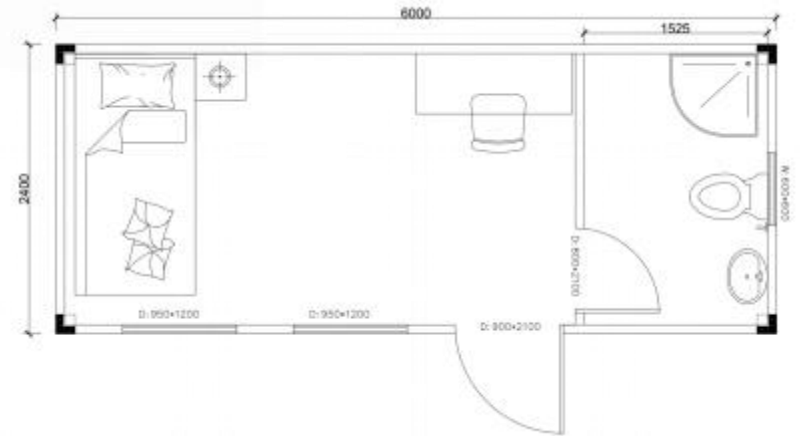

CONFIGURATIONS

Seniors Module

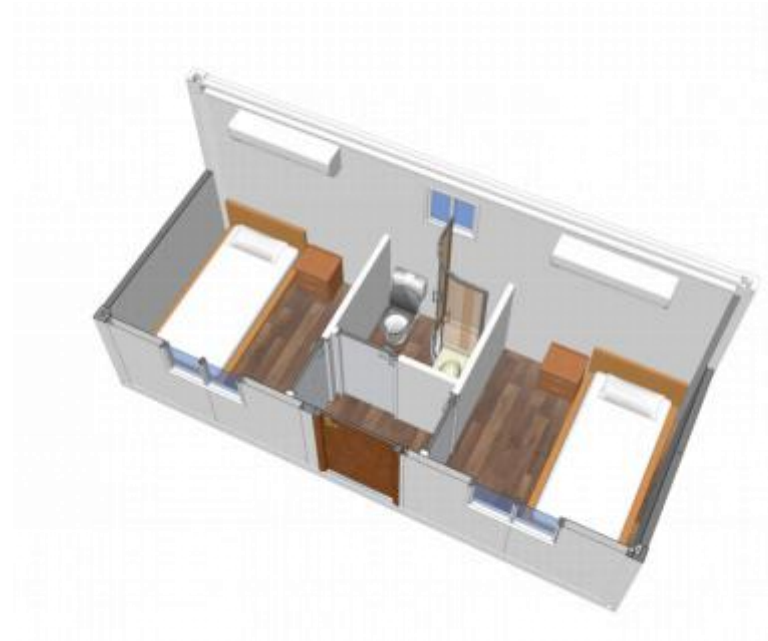
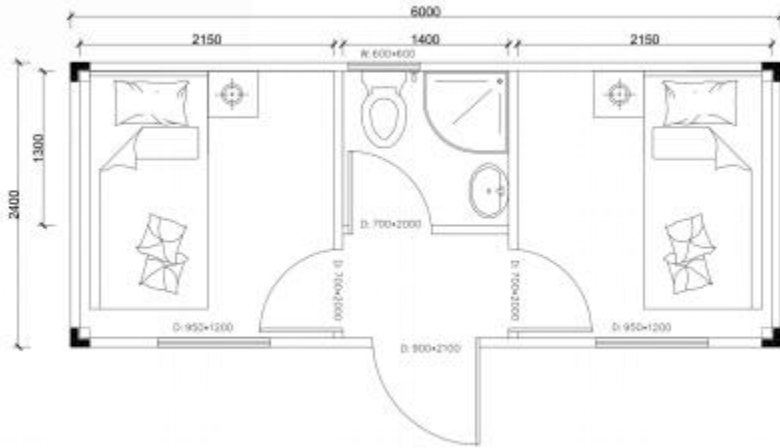

CONFIGURATIONS



Seniors Module

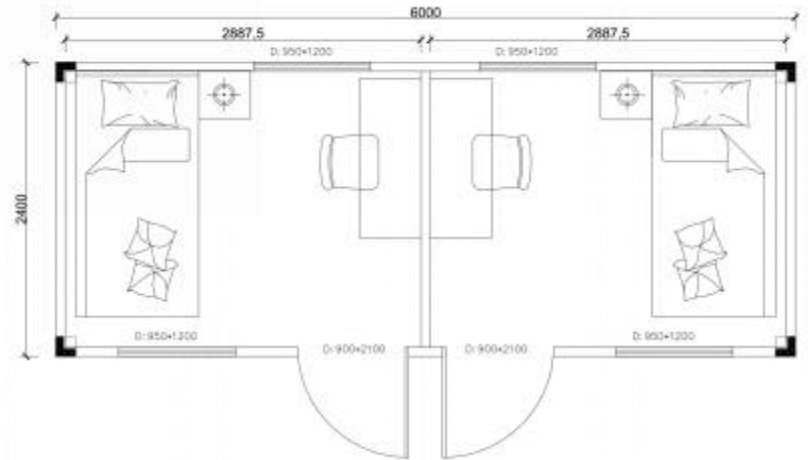

CONFIGURATIONS

Toilet

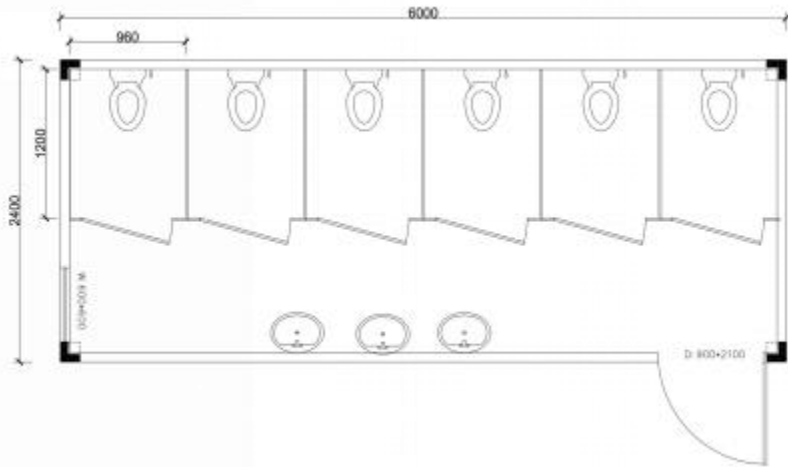

CONFIGURATIONS



Office

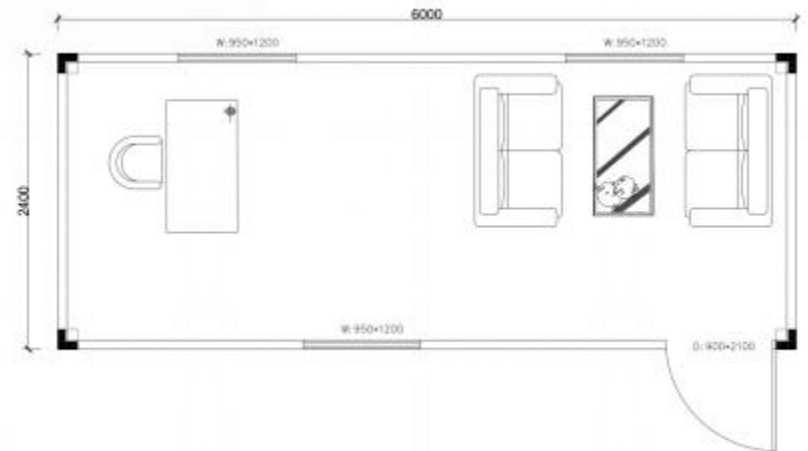

CONFIGURATIONS

Shower Module

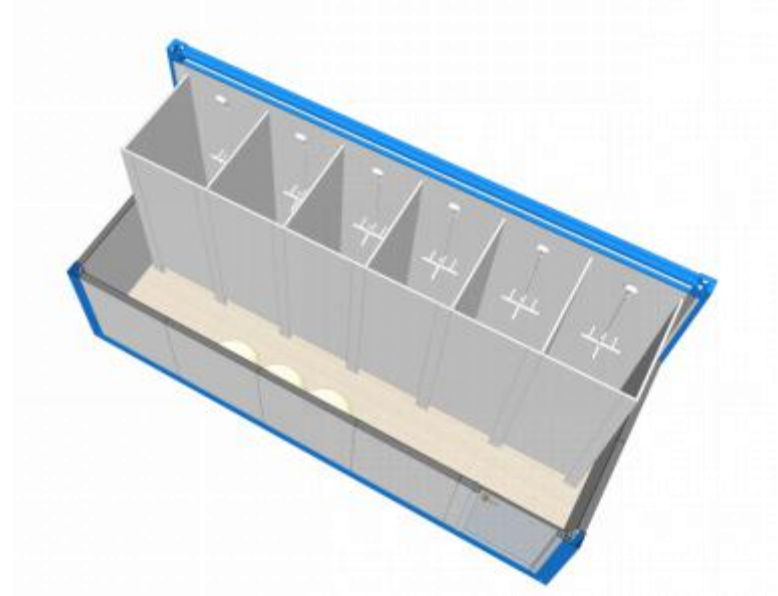
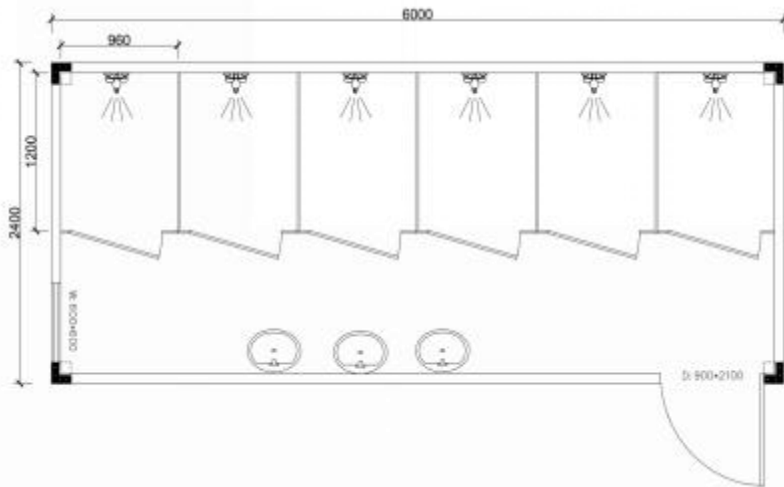

CONFIGURATIONS

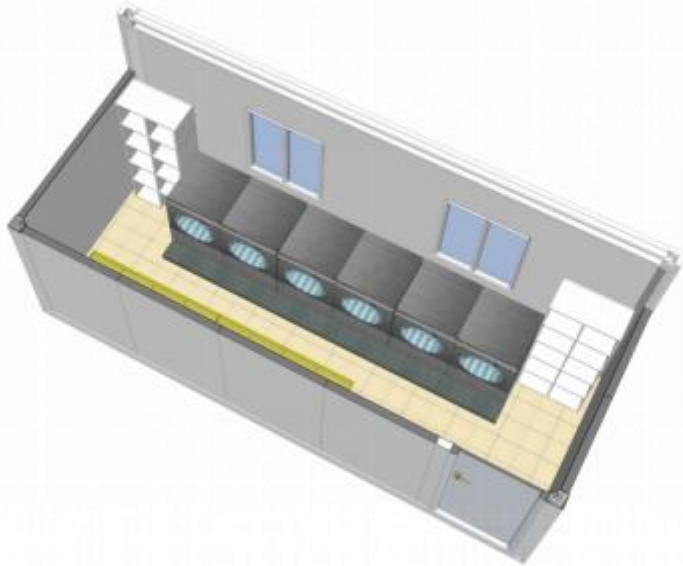

Laundry Module

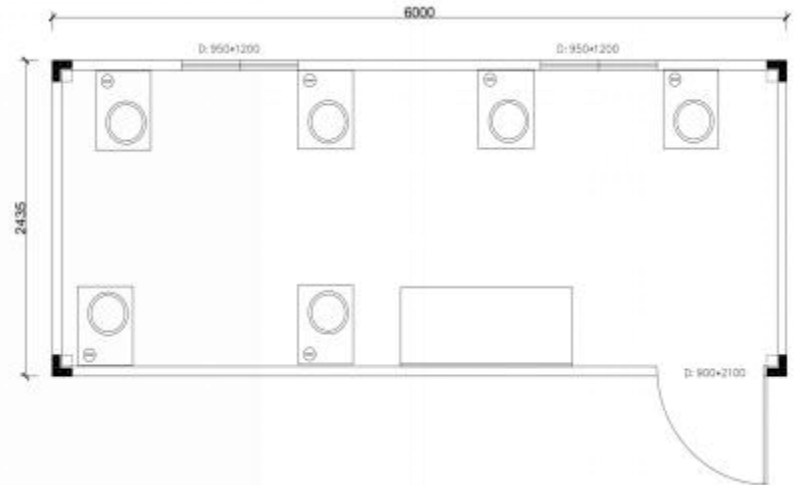

CONFIGURATIONS

Seniors' Mess Module

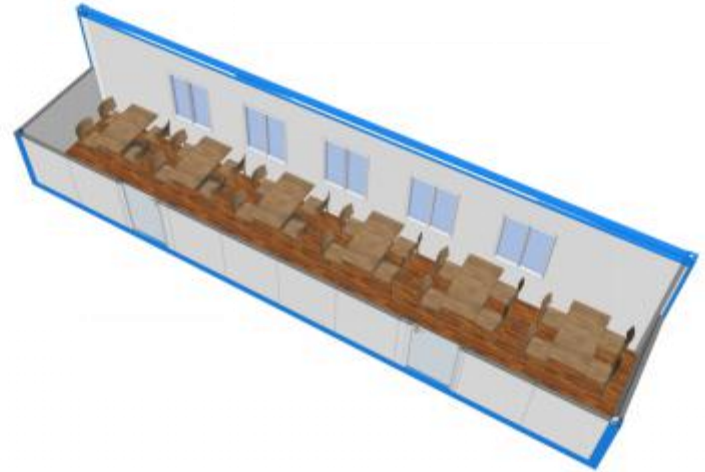
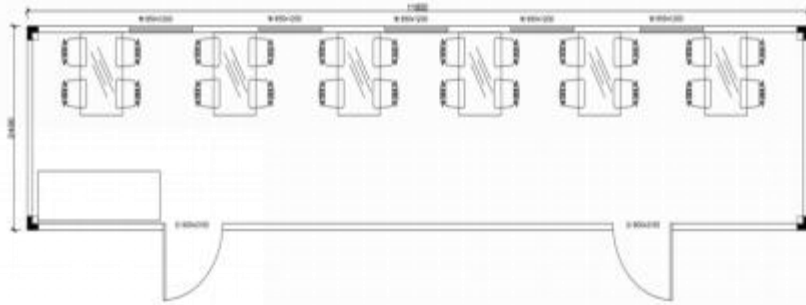

CONFIGURATIONS

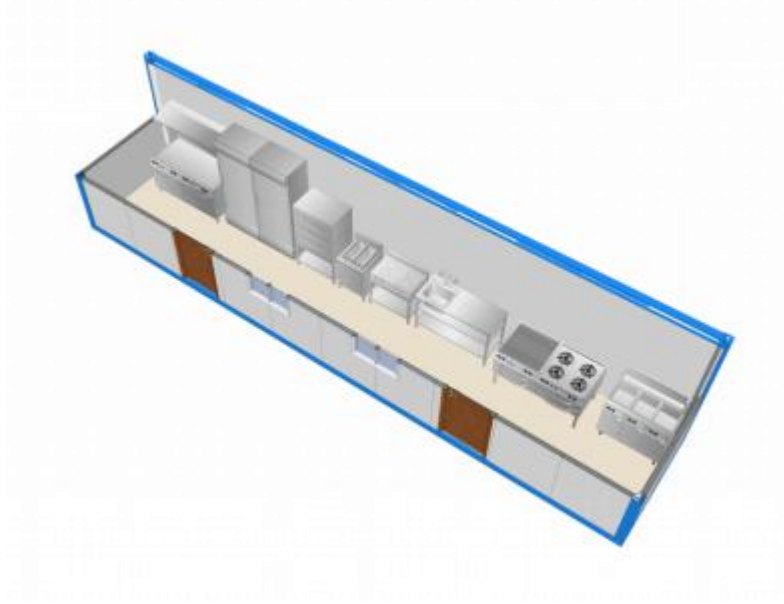

Kitchen Module

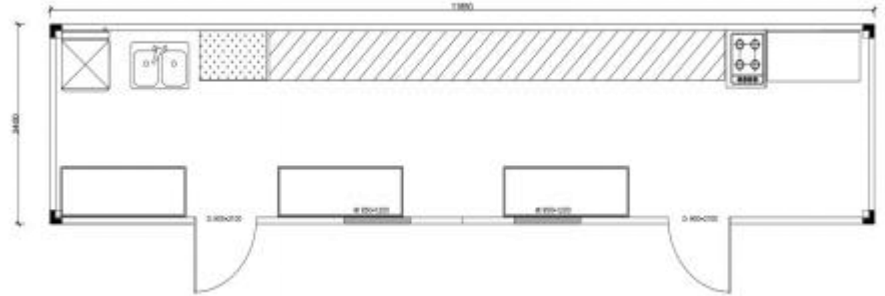

CONFIGURATIONS

Storage/Data Module

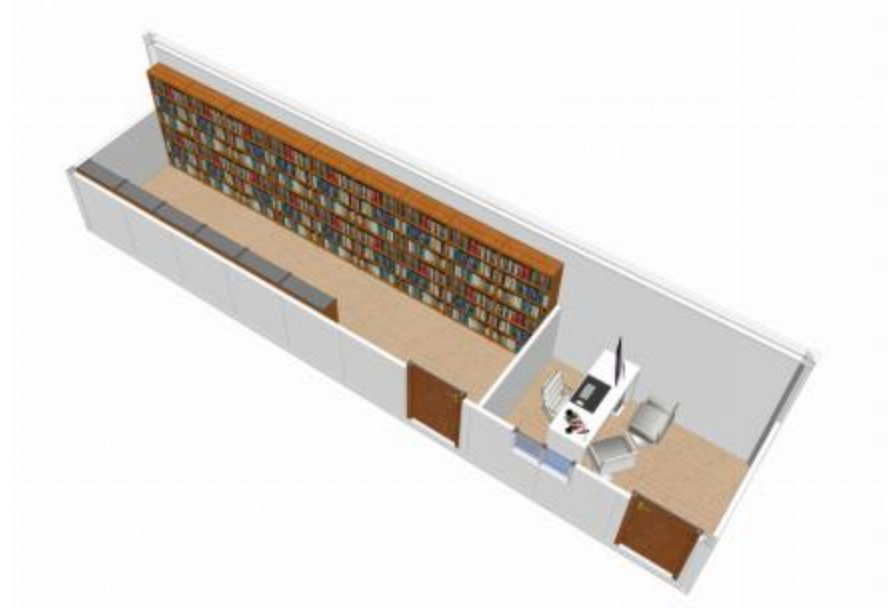
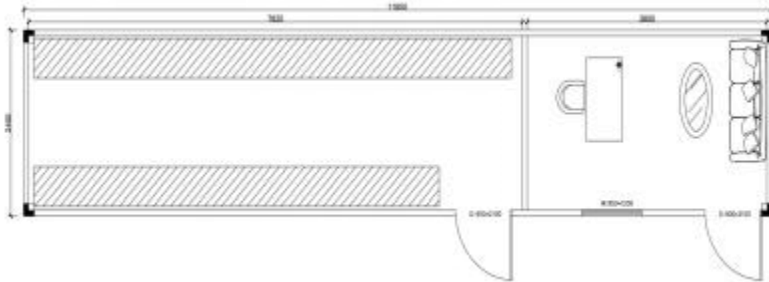

CONFIGURATIONS



Medical Module



CASE-REFUGEE CAMP



BRIEF

- Location: Germany
- Client: EBV-group
- Date of Development: 2016



CASE-CONSTRUCTION CAMP

Excellent Temporary Space Solution Provider



BRIEF

- Location: El-Salvador
- Client:
- Date of Development: 2016



CASE-HOSPITAL



BRIEF

- Location: China
- Client: Xuanwu Hospital
- Date of Development: 2015



CASE-SCHOOL



BRIEF

- Location: China
- Client: Tangshan School
- Date of Development: 2015



CASE-HOTEL



BRIEF

- Location: El-Salvador
- Client: THEME
- Date of Development: 2016



MORE CASES



MILITARY CAMPING HOUSE



VICE CENTER PROJECT



EXHIBITION HALL



MORE OTHER SYSTEM SOLUTION

FOLDING CONTAINER SYSTEM

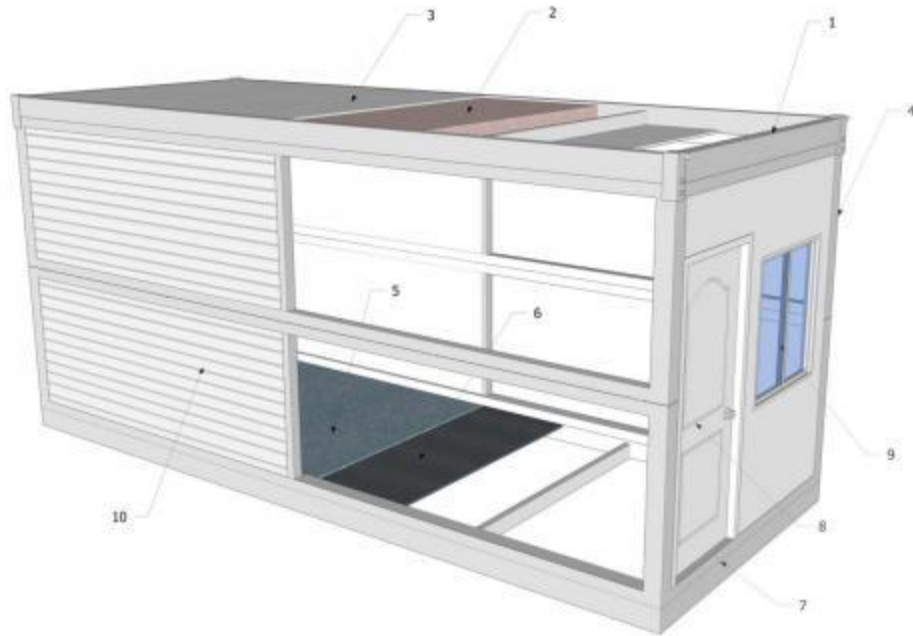

SIZE:
5800*2450*2500mm

REFERENCE



BRIEF

- Location: Panama
- Client: Parrillada
- Date of Development: 2019



PREFABRICATED BUILDING SYSTEM

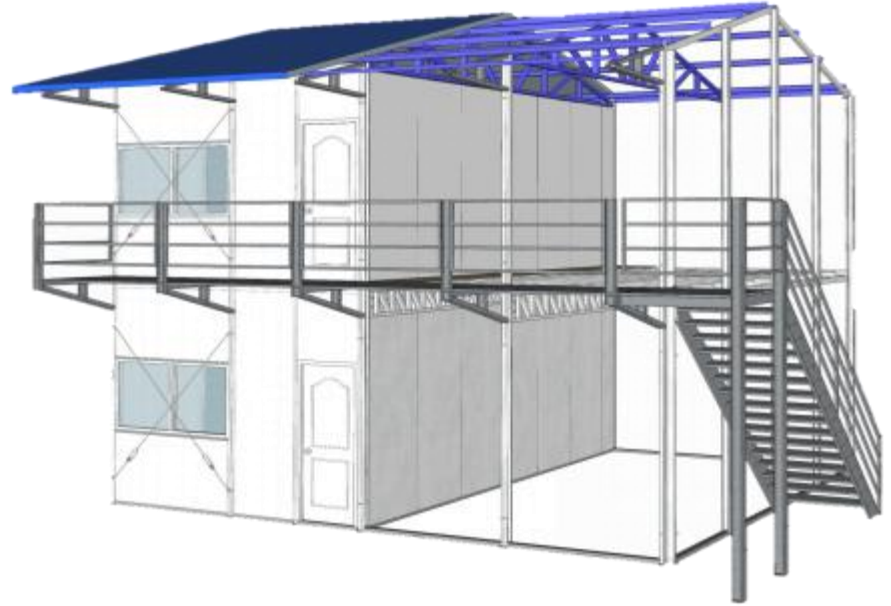
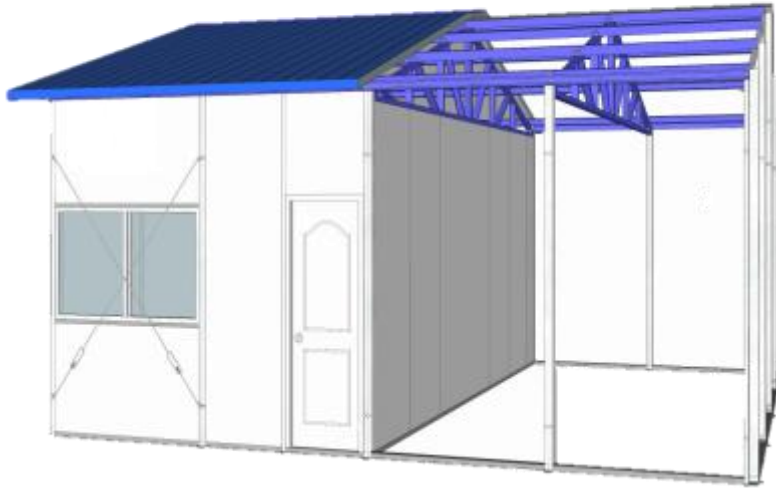

REFERENCE



BRIEF

- Location: El-Salvador
- Client: UMMO
- Date of Development: 2017



PARTNERS & CLIENTS



BINDURA UNIVERSITY
OF
SCIENCE EDUCATION

THANKS FOR WATCHING

Welcome to contact us seek suitable solution for your project.

Email: admin@qualityprefabhouse.com

Tel: +86 13153691144

Tel: +86 18763607285